

Finolex

XCEEDS XPECTATIONS

SMART DOOR LOCKS



PRODUCT CATALOGUE

SMART DOOR LOCKS

Features



Smart door locks offer convenient features such as keyless entry, remote access, and the ability to control and monitor the lock from anywhere using a smartphone or other connected devices.



Security

Smart door locks come with advanced security features such as encryption, authentication, and tamper detection, which provide enhanced protection against unauthorized access.



Multiple User Access

Smart door locks allow users to create multiple user profiles with different access permissions. This can include family members, guests, or employees, with varying levels of access rights and schedules, allowing for flexible access control and customization.



Modern Aesthetics

Smart door lock features sleek and modern designs that can complement the aesthetics of modern homes and businesses.

MRP ₹35,800

Experience Safety Redefined



Low Battery Alarm



Bell Button



Wrong Password Blocking



Smart Home App

High-level Security Against Thefts



Fingerprint Mode



Pincode Mode



RFID Mode



Mechanical Key



FCL 5 Pro

Dual-function Handle For Left Or Right-opening Doors

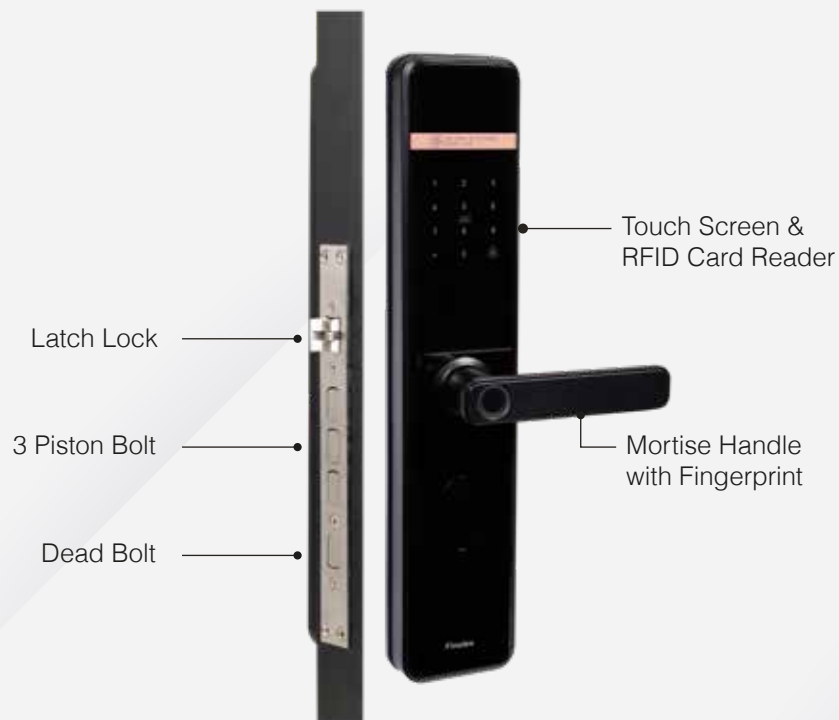

Keyless Entry For Endless Convenience



Admin Entry



User Entry



Guest Entry



Periodic Entry with App



One Time User Entry



Mechanical Key



FCL-2 Pro

MRP ₹30,000



Designed For Entrance Door & Inner Doors



Can Be Operated Through Mobile App/Wifi



CMOS Technology For Biometric Sensor



Can Be Operated By Using Biometrics, RFID Card, Numeric, Password & Mechanical Key



Low Battery Alarm



Double Strobe Security



Mechanical Key

FCL-01 with VDP Function _____

MRP ₹60,400



Designed For External Doors



Triple Strobe Security



Can Be Operated Through
Mobile App/Wifi



Can Be Operated By Using Biometrics,
RFID Card, Numeric, Password & Mechanical Key



Low Battery Alarm



Mechanical Key



CMOS Technology
For Biometric Sensor

FCL-01

with built in Video Camera & Face Recognition

MRP ₹68,600



Triple Strobe Security



With USB Power Port Facility
(Others Provide Only 9 Volt Battery Port)



CMOS Technology For Biometric Sensor
(Others Only Provide Progressive Sensor)
& Usable Up To 100 Fingerprints



Child Lock Enabled



Instruction For Complete Setup Given
In English (Indian Accent)



Can Operate through A Mobile App



OLED Display (Others Only
Provides LED Which Is Not
Clearly Visible At Night)



Fully Automatic
Mechanism



In-built Private
Door Bell



Upper Cover Is
Touch Operated



Mechanical Key

Door Bell Lock

COMING SOON



Designed for External & Internal Doors



CMOS Technology for Biometric sensor



It can be operated using Fingerprint, Password, Anti-Peeping Password & Mechanical Key



Double Strobe Security



Hidden Mechanical Key



Lock has 10,000 mAh battery pack



Support WiFi door lock + 2K HD camera+doorbell



Camera supports 4:3 aspect ratio image



2 Way Audio: Smart deadbolt with camera supports remote monitor and video call. Users could communicate to visitors by App.



Built-in WiFi. Users could remotely unlock the front door via the App. App could generate and share one time codes to visitors and family.



Fit for both the left and right door directions. Deadbolt lock fit door thicknesses from 1-3/8" to 2-1/8" (35mm - 55mm), backset 2-3/8" (60mm) and 2-1/8" (70mm).

Door Lock Dimensions

Sr. No	Digital Door Lock Model	Dimensions	Door Thickness	Backset
1	FCL 2 Pro	Front : 60(W) x 250(H) x 68(D) mm Main : 60(W) x 250(H) x 68(D) mm	35 - 100mm	60mm
2	FCL 5 Pro	Front : 77(W) x 381(H) X 70(D) mm Main : 77(W) x 381(H) X 70(D) mm	45 - 90mm	60mm
3	FCL 01 (VDP)	Front : 75(W) x 425(H) x 75(D) mm Main : 75(W) x 425(H) x 75(D) mm	45 - 90mm	60mm
4	FCL 01 (VDP & FRG)	Front : 75(W) x 425(H) x 75(D) mm Main : 75(W) x 425(H) x 75(D) mm	45 - 90mm	60mm



Send us a Hi!
on **20-27506219**
to register your
complaint.

About us

Finolex Cables is amongst India's leading electrical and telecommunication cable companies. It is rapidly transforming from a manufacturer of wires and cables into an electrical products company, by expanding its product portfolio to market products like lighting, water heaters, fans, switches, switch gears, electrical conduits & room heaters. Further reinforcing its reputation of offering innovative products that cater to the needs of modern households.

Recognizing the undeniable benefits associated with large volumes, Finolex Cables has enhanced its capacities at its state-of-the-art manufacturing facilities spread across Goa, Maharashtra and Uttarakhand. To give flexibility to its supply chain, Finolex cables has established a network of 600 distributors, 4000 channel partners and over 1,50,000 retailers, all connected by an effective SAP system.

Finolex Cables is constantly working to introduce innovative technologies & enhancing technical competencies while prioritizing customer requirements, quality and environmental concerns. A modest journey that began in 1958 has spanned a course of six eventful decades.

Finolex
:DELIGHT

Customer Care
1800-209-0166
customercare@finolex.com

Finolex
Cables Limited

26-27, Mumbai-Pune Road, Pimpri, Pune - 411018, India. Tel: 020-27506200 | Visit us at: www.finolex.com | Email: sales@finolex.com | CIN: L31300MH1967PLC016531

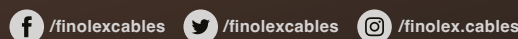

FOR TECHNICAL LITERATURE PLEASE CONTACT OUR BRANCH OFFICES: Ahmedabad : Tel: 079-26584637 / 26575639 | Bengaluru : Tel: 9845278680 | Bhubaneswar : Tel: 0674-2971188, 2971922 | Chennai : Tel: 044-28231514/28284141 | Chandigarh : Tel: 9316064670 | Cochin : Tel: 9880088155 | Coimbatore : Tel: 0422-2330997 | Dharwad : Tel: 9880088155 | Goa : Tel: 0832-2782003 / 2782065 | Gurgaon : Tel: 9896763770 | Guwahati : Tel: 9435324398 | Indore : Tel: 7314911723 | Jaipur : Tel: 9929111411 | Kolkata : Tel: 0522-4035031 | Lucknow : Tel: 9560299393 | Mumbai : Tel: 022 - 22820062 | New Delhi : Tel: 9870170171 | Patna : Tel: 9934107999 | Pune : Tel: 020 - 27506200 | Raipur : Tel: 7008336581 | Ranchi : Tel: 8101383841 | Secunderabad : Tel: 040 - 27811161 | Uttarakhand : Tel: 9760045003 | Vadodara : Tel: 9879555568 | Vijayawada : Tel: 9848043967

ALL INFORMATION GIVEN HEREIN IS IN GOOD FAITH. FINOLEX SHALL NOT BE LIABLE FOR ANY DAMAGES ARISING OUT OF INCORRECT USE OR INTERPRETATION.

In order to derive maximum benefit and utilisation of our products, we advise that these products are stored, installed and commissioned as per the norms prevailing in the place of installation. When decommissioned, these should be disposed using appropriate methods/process specified in respective state / location of use so as not to affect the environment adversely.